

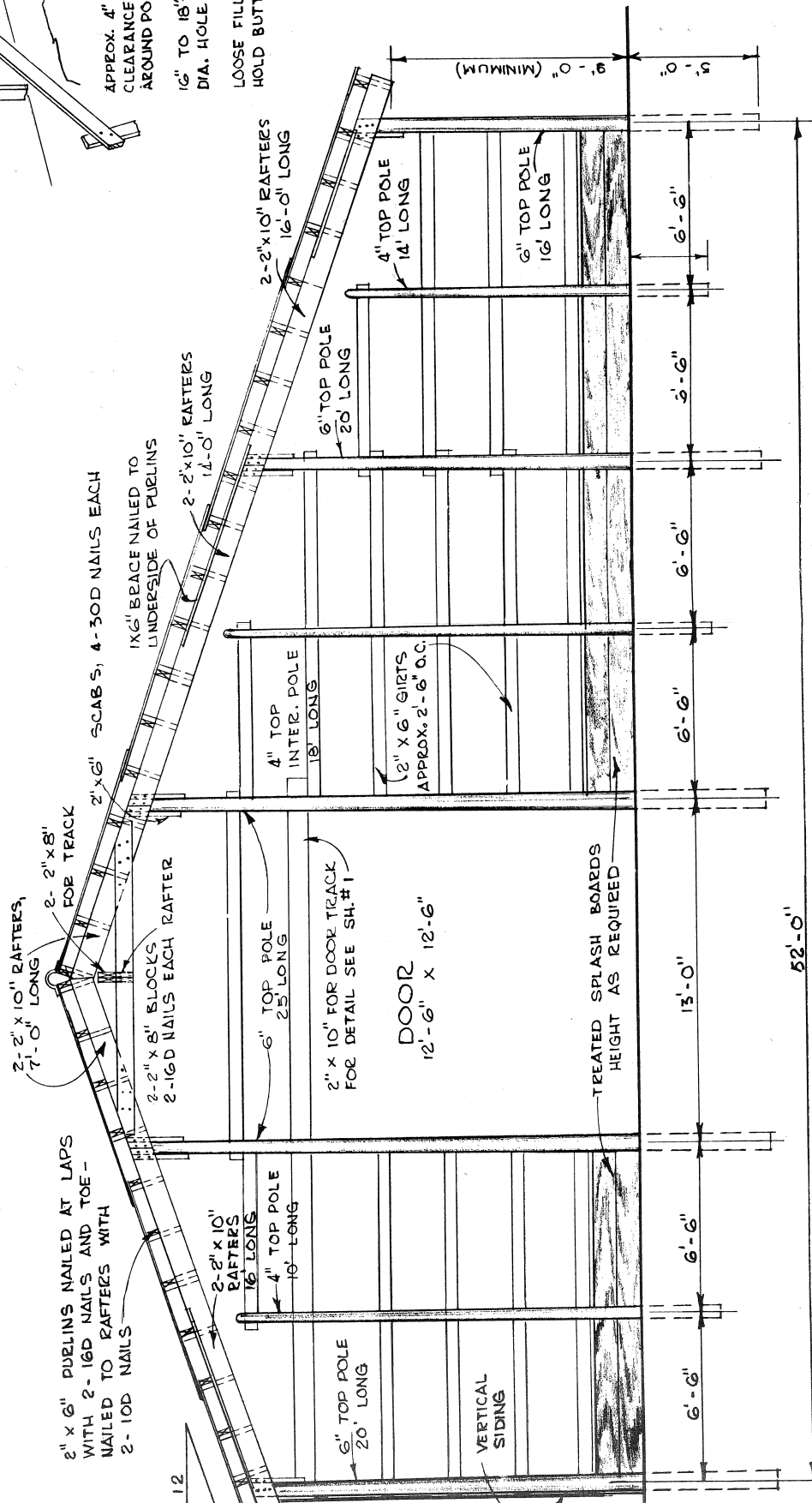

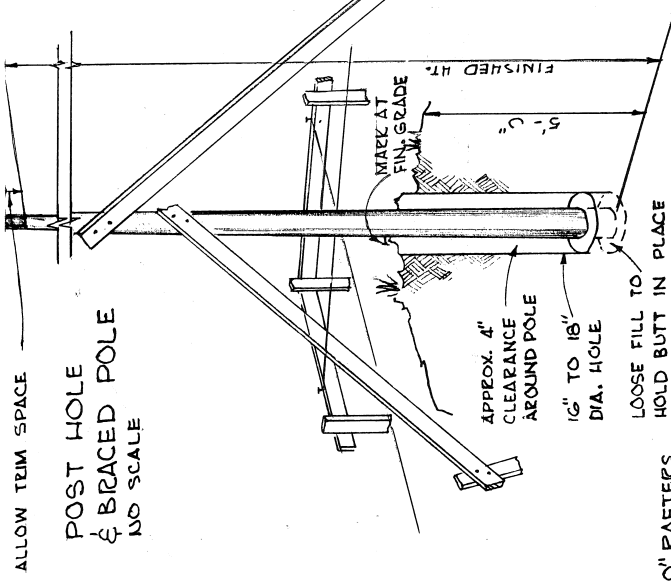

NOTE:  
 ROOFING: PURLIN SPACING, NOT TO EXCEED 2'-0" FOR .024", 2 1/2" CORRUGATED ALUM. OR 2-G GA. 2 1/2" CORRUGATED GALVANIZED STEEL. SIDE LAP SHEETS AT LEAST 1 1/2" CORRUGATIONS. END LAPS 6" MIN. USE 2 1/2" CORRUGATED BRIDGE ROLL, LUMBER NOMINAL: ALLOWABLE FIBER STRESS = 1500 PSI FOR PURLINS, 1200 PSI FOR RAFTERS. IF METAL SIDING IS USED, NAILING GIRTS TO BE SPACED TO CONFORM TO MFG. DIRECTIONS



CROSS SECTION SHOWING END WALL FRAMING (SCHEME 2.)



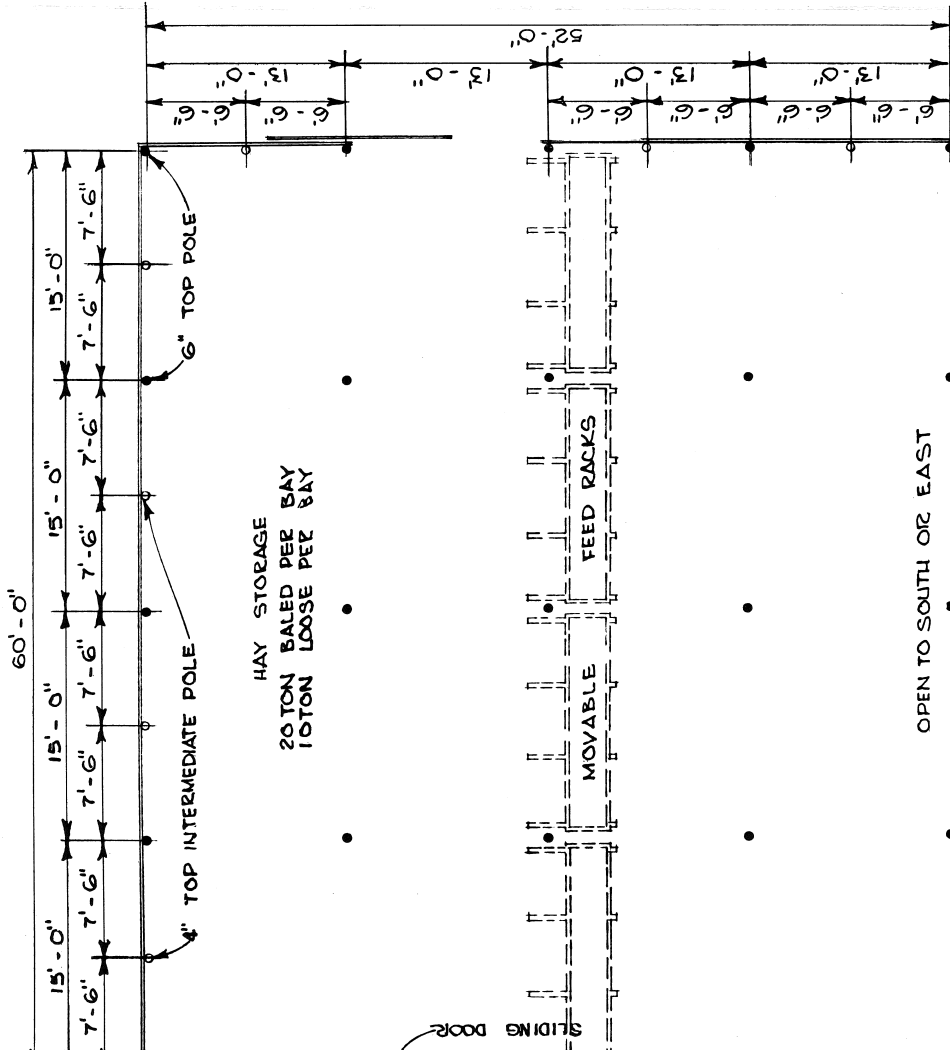

FLOOR PLAN (SCHEME 2.)  
SCALE 1/8" = 1'-0"

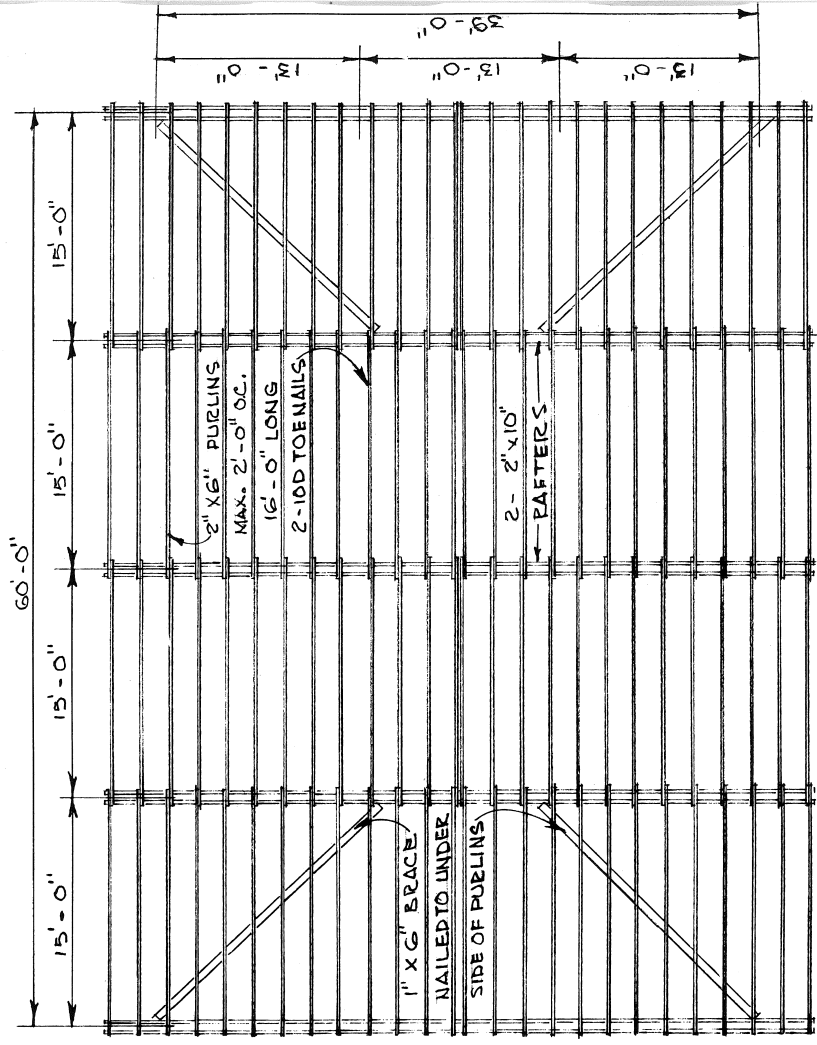

ROOF FRAMING PLAN (SCHEME 1.)  
SCALE 1/8" = 1'-0"

## Disclaimer

This site makes available conceptual plans that can be helpful in developing building layouts and selecting equipment for various agricultural applications. These plans may be outdated and do not necessarily represent the most current technology, construction codes, or agricultural practices. They are not construction plans and do not replace the need for competent design assistance in developing safe, legal and well-functioning agricultural building system. The University of Arkansas Cooperative Extension Service, the United States Department of Agriculture and none of the cooperating land-grant universities warranty these plans.