

SIDE ELEVATION

SCALE: 3/16" = 1'-0"

14' Pole 5" top

2 1/2" Corrugated Metal Roofing

2" x 6" Rafter

2" x 4" Girts 2'-0" o.c.

1/2" Plywood Braces

2" x 6" Brace

2" x 12" Purlin

1/2" Plywood Brace

2" x 6" Cleats

2" x 8" Nailing Strip

Note
In 14' bay, 2" x 6", 2" x 10", & 2" x 12"
purlins will be replaced by 2" x 10",
2" x 12", & 2" x 14" respectively.

2 1/2" Corrugated Metal Siding

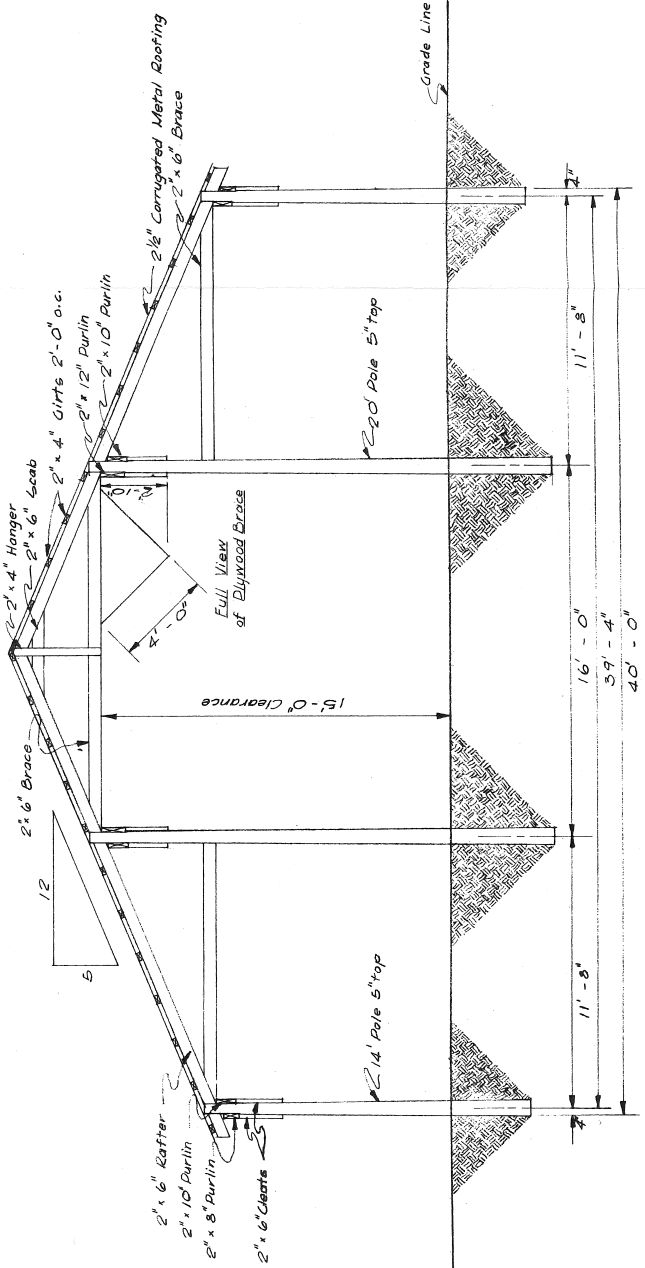

SECTION B-B

(Showing optional metal siding)

SCALE: 3/8" = 1'-0"

FARM IMPLEMENT SHED
AGRICULTURAL EXTENSION SERVICE
University of Arkansas College of Agriculture and Home Economics
U. S. Department of Agriculture Cooperating
PLAN NO. 586029
SHEET 1 OF 2

SECTION A A

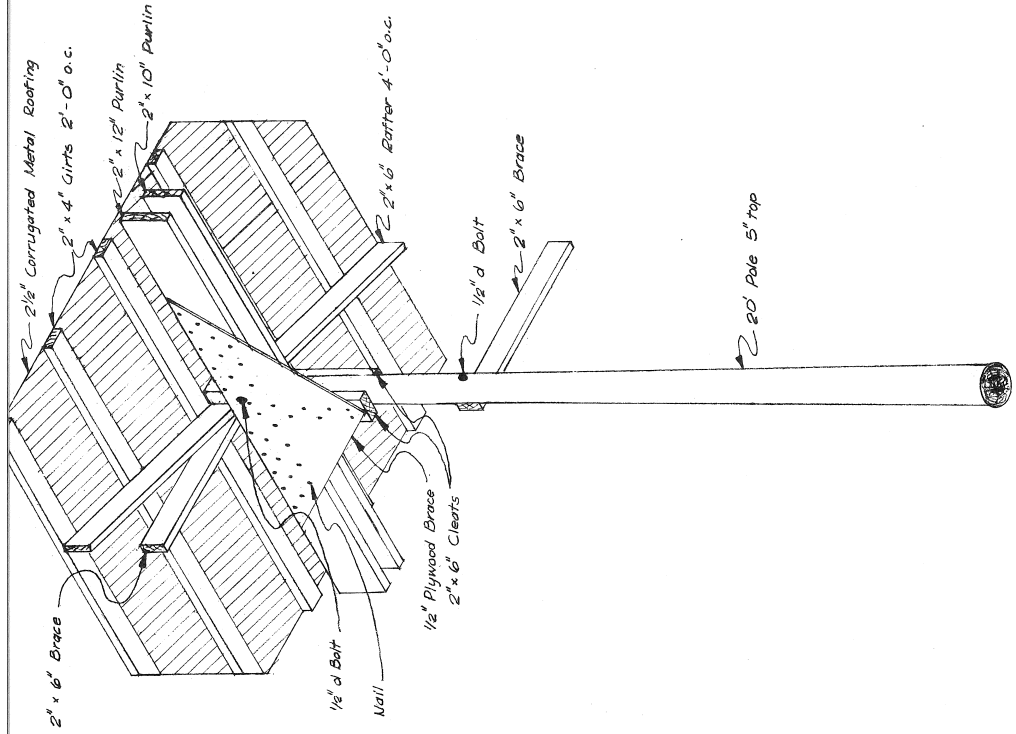

FRAMING DETAIL

SCALE: 3/8" = 1' - 0"

FARM IMPLEMENT SHED
AGRICULTURAL EXTENSION SERVICE
University of Arkansas College of Agriculture and Home Economics
U. S. Department of Agriculture Cooperating
PLAN NO. 586029
SHEET 2 OF 2

FLOOR PLAN & FRAMING DETAIL

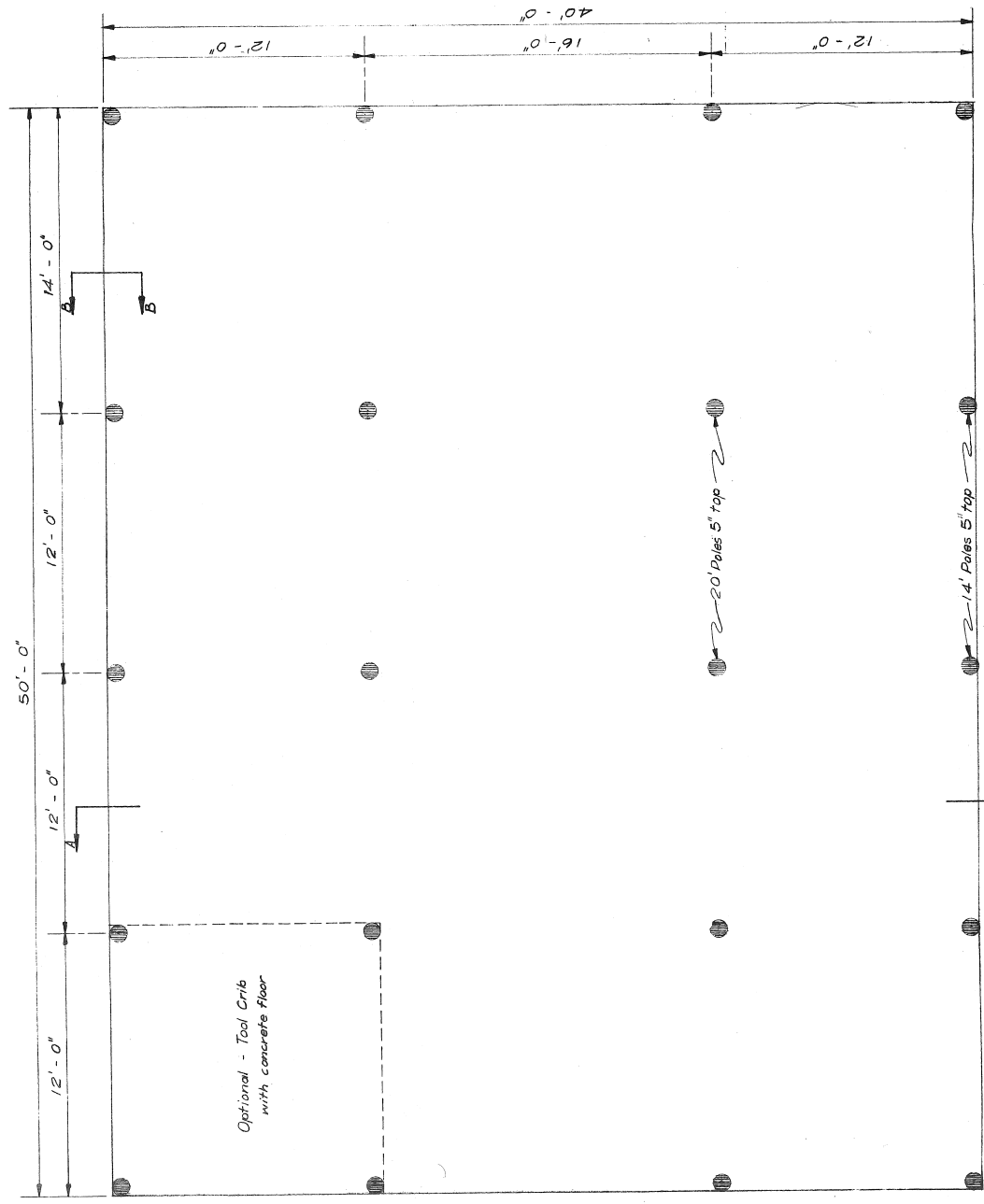

FLOOR PLAN

SCALE: 3/16" = 1' - 0"

Disclaimer

This site makes available conceptual plans that can be helpful in developing building layouts and selecting equipment for various agricultural applications. These plans may be outdated and do not necessarily represent the most current technology, construction codes, or agricultural practices. They are not construction plans and do not replace the need for competent design assistance in developing safe, legal and well-functioning agricultural building system. The University of Arkansas Cooperative Extension Service, the United States Department of Agriculture and none of the cooperating land-grant universities warranty these plans.